

DB-14 系列电源插座

Rating:

15A 250V AC T105  Approval

10A 250V AC  Approval

Insulation resistance: 100MΩ(min) 500V DC

Dielectric withstand voltage: 2500V AC 5s Between terminals

DB-14-1

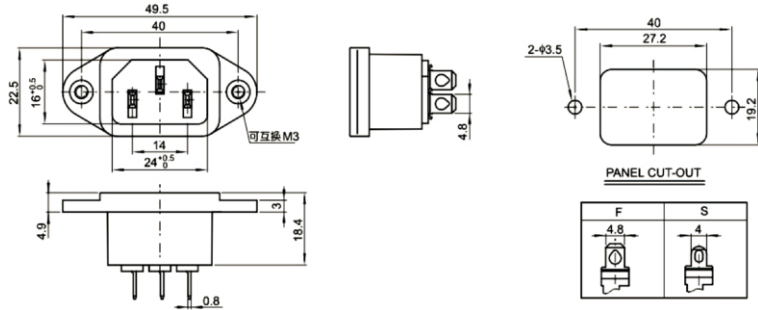
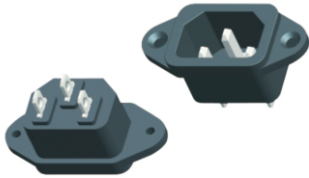

DB-14-1P

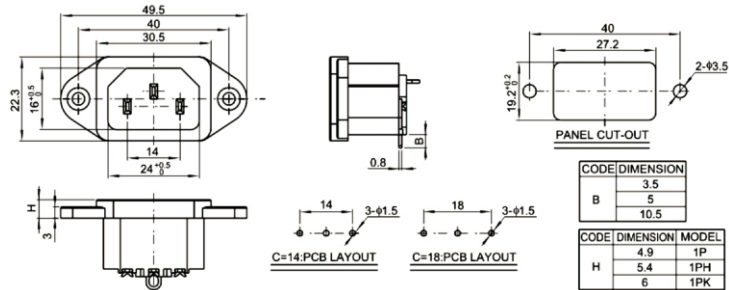

DB-14-10

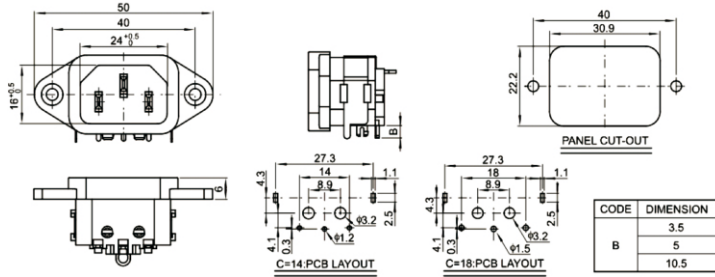
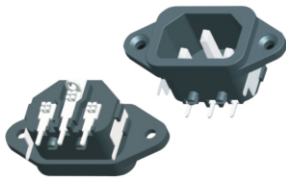

DB-14-1A

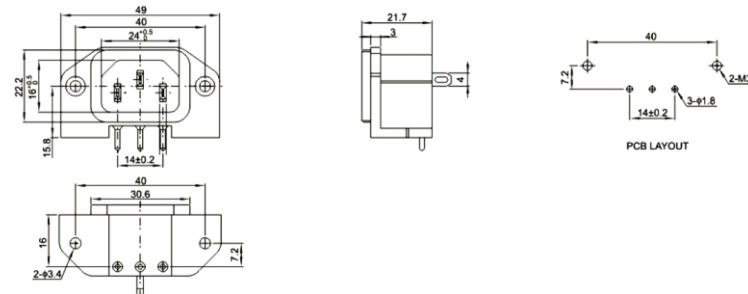
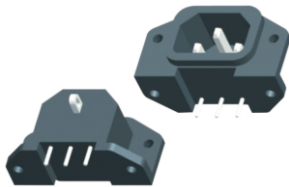

DB-14-2

